

INITIAL RECEIPT

United States Department of the Interior
Bureau of Land Management
 DIV OF LANDS, MINRLS & ENERGY
 ONE N CENTRAL AVE
 PHOENIX, AZ 85004 -4427
 Phone: 602-417-9200

Receipt	
No:	4719196

Transaction #: 4844341
Date of Transaction: 03/25/2020
CUSTOMER:
BILL C WALDECK PO BOX 566 RIMROCK, AZ 86335-0566 US

LINE #	QTY	DESCRIPTION	REMARKS	UNIT PRICE	TOTAL
1	1.00	LOCATABLE MINERALS / MINING CLAIMS-NEW, UNADJUD, ONE OR MORE AUTH NOS / NEW MINING CLAIM PROCESSING FEE CASES: AMC459607/\$20.00		- n/a -	20.00
2	1.00	LOCATABLE MINERALS / MINING CLAIMS-NEW, UNADJUD, ONE OR MORE AUTH NOS / NEW MINING CLAIMS LOCATION FEE CASES: AMC459607/\$40.00		- n/a -	40.00
3	1.00	LOCATABLE MINERALS / MINING CLAIMS-NEW, UNADJUD, ONE OR MORE AUTH NOS / NEW MINING CLAIMS MAINTENANCE FEE CASES: AMC459607/\$165.00		- n/a -	165.00
TOTAL:					\$225.00

PAYMENT INFORMATION			
1	AMOUNT:	225.00	POSTMARKED: N/A
	TYPE:	CHECK	RECEIVED: 03/25/2020
	CHECK NO:	2779	
	NAME:	ARIZONA NATURAL GOLD ESCAVATION BOX 566 RIMROCK AZ 86335-0566 US	

REMARKS

This receipt was generated by the automated BLM Collections and Billing System and is a paper representation of a portion of the official electronic record contained therein.

ENTERED
 APR 02 2020
 BY: RAM

CORRESPONDENCE

TRANSFERS

MAINTENANCE FEES

WAIVERS

POL/NOI

MISCELLANEOUS

**LOCATION NOTICES
AMENDMENTS
STATUS SHEET
GEO REPORT/MTP**

MINING CLAIM STATUS REPORT

Data Entered: 4/2/2020

MTP Checked By: 4/2/2020
GEO Checked By: 4/2/2020

LEAD SERIAL NUMBER: AMC 459607 thru AMC _____

NUMBER OF CLAIMS & TYPE:

1 LODE
____ PLACER
____ ASSOCIATION PLACER
____ MILL SITE
____ TUNNEL SITE

CHARGES:

Processing Fee @ \$20 = \$ 20
Location Fee @ \$40 = \$ 40
Maintenance Fee @ \$165 = \$ 165
Add'l Maint Fee for Assoc Placer = \$ _____
SUBTOTAL \$ _____
Other Fees \$ _____
Other Fees \$ _____
TOTAL \$ 225

TOTAL ACREAGE: _____ Per Claim
(Placer Only)

NUMBER OF LOCATORS: _____

DOCUMENTS RECEIVED VIA: Over-the-Counter [] Mail [] **TIMELY FILED:** Yes [] No []

LEGAL DESCRIPTION: T 8N R 1W SEC 3, 4
T _____ R _____ SEC _____
T _____ R _____ SEC _____
T _____ R _____ SEC _____
T _____ R _____ SEC _____

BLM [] FOREST SERVICE [] _____ SUBJ TO PL 359: Yes [] No []
WILDERNESS AREA [] _____

SPLIT ESTATE: N/A [] SX [] PX [] OTHER [] _____
SRHA [] Was proper Notice filed if located on SHRA Land? Yes [] No []

RECONVEYED MINERALS ON BLM LAND REQUIRE OPENING ORDER FROM 1944 TO 1993:

Open to Entry On _____ N/A []

COMMENTS/STATUS: VOID [] PARTIALLY VOID [] PVT MINERALS [] WITHDRAWN LANDS []
OTHER [] _____

[] Claimant acknowledges that portions of the following claim(s) site(s) may be void or voidable.

Printed Name of Claimant _____ Signature of Claimant _____

*****FINAL ADJUDICATION*****

DATE _____ INITIALS _____

AMC459607

MAIL TO:
BILL WALDECK
P.O. BOX 566
Rim Rock, AZ
86335

LOCATION NOTICE FOR LOPE MINING CLAIM

Amendment BLM Serial # _____

NOTICE IS HEREBY GIVEN that the _____
ANGEX #1 lode mining claim has been located
by BILL C. WALDECK whose current mailing
address is P.O. BOX 566
RIM ROCK, AZ 86335

RECEIVED
BLM AZ STATE OFFICE
2020 MAR 23 A 10:42
PHOENIX, ARIZONA
BLM
Date
Stamp

The general course of this claim is SW TO NE and it is situated in YAVAPAI
County, Arizona. This claim is 1500 feet in length and 600 feet in width.

20.0 Total Claim Acreage. This claim runs from the location monument on which this location notice
is posted on the centerline of the claim approximately 1500 feet in a NE direction to the NE
end line and 1500 feet in a SW direction to the SW end line. This claim is marked by six
monuments, one at each corner and one at the center of each end line of the claim.

The location monument on which this notice is posted is situated within Section 4, Township 8N
Range 1W, Gila Salt River Base and Meridian, Arizona and this claim encompasses portions
of the following quarter section(s), section(s), Township(s) and Range(s) NE 1/4 SEC 4, T8N, R1W
NW 1/4 SEC. 3, T8N, R1W

Gila Salt River Base and Meridian, Arizona.

The locality of this claim with reference to some natural object or permanent monument and additional information
(if any) concerning its locality are as follows: THE SE CORNER OF ANGEX #1
IS APPROX. 300' NE FROM BRASSCAP - SEC 4, 1/2 SECTION,
EAST SIDELINE, T8N, R1W The above information is shown on the attached map.

DATED AND POSTED on the ground this 2nd day of JANUARY, 2020

LOCATOR(s) AGENT

Print Name(s) BILL C. WALDECK
Signature(s) Bill C. Waldeck

AMS
459607

Form MCF100
Revised July 2014

MINING CLAIM MAP

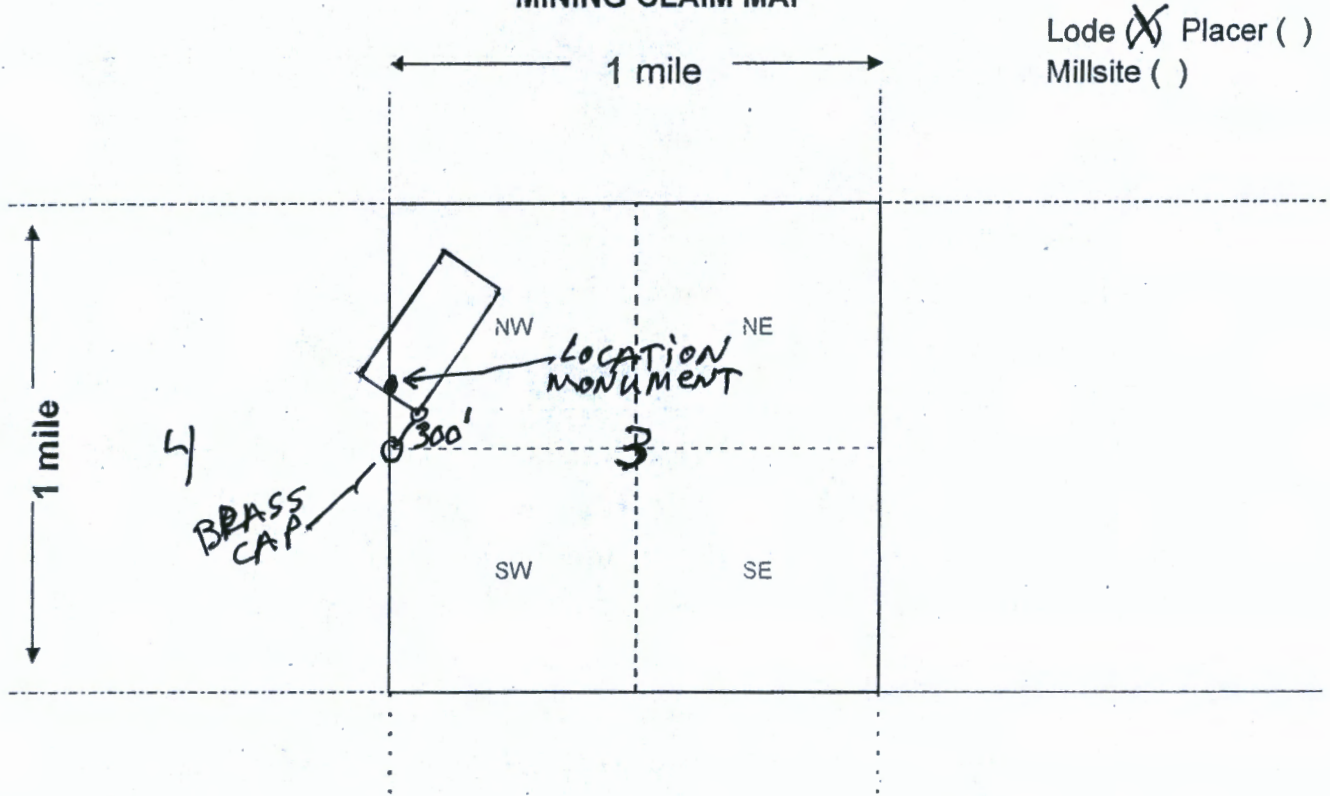

Lode (X) Placer ()
Millsite ()

Scale: 1" = 2000 feet



1. The above map depicts the ANGEX #1 mining claim, which is located in Section (s) 3-4, Township 8 N, Range 1 W, Gila and Salt River Base and Meridian, YAVAPAI County, Arizona. Total claim acreage is 20.0

2. The type of corner and location monuments used are as follows: 1 1/4" X 5' TALL PVC Pipe

3. The bearings and distances in degrees and feet between claim corners and to a public land survey monument are as depicted on the map.

4. If the claim is a placer or millsite claim with exterior limits conforming to legal subdivisions of the public survey, provide a legal description of the claim _____

Form MCF100a
Revised July 2014

Date and Time Run:
4/2/2020 3:28:57 PM

**DEPARTMENT OF THE INTERIOR
BUREAU OF LAND MANAGEMENT
Case Recordation**

Page 1 of 1

Geographic Report with Land

Disposition is equal to **AUTHORIZED , CANCELLED , EXPIRED , PENDING , REJECTED , RELINQUISHED ,
WITHDRAWN**
and Meridian Township Range Section is equal to **14 0080N 0010W 003 , 14 0080N 0010W 004**
and Admin State is equal to **AZ**

**NO WARRANTY IS MADE BY BLM
FOR USE OF THE DATA FOR
PURPOSES NOT INTENDED BY BLM**

DEPARTMENT OF THE INTERIOR
BUREAU OF LAND MANAGEMENT
Case Recordation
Geographic Report with Land

Admin State: AZ
Geo State: AZ

Serial Number	Total Case Acres:	Casetype	Case Disp	Mer	Twp	Rng	Sec	Sur Type	Sur Nr	Surf	Subdivision	Act Pend
AZA 033817	10.384	281001	AUTHORIZED	14	0080N	0010W	003	ALIQ			SWSW	
AZA 030528	20.610	281001	AUTHORIZED	14	0080N	0010W	004	ALIQ			SWSW	
	20.610							W10			2	
AZA 030598	1.000	283200	EXPIRED					FF		1	PORTION OF:	

W
Bill Waldeck
P.O. Box 566
Rimrock, AZ 86335

CERTIFIED MAIL®



7019 0160 0000 4352 7722



1000



85004

PHOENIX
AZ 86335
18 MAR 20
PH101

U.S. POSTAGE PAID
FCM LETTER
RIMROCK, AZ
86335
MAR 18, 20
AMOUNT

\$6.95

R2304W121210-08

RECEIVED
RIMROCK, AZ

2020 MAR 23 A 10:42

PHOENIX, ARIZONA

BUREAU OF LAND MANAGEMENT
ATTN.-MINING
1 N. CENTRAL AVE
Suite 800

PHOENIX, AZ

85004-442700



RETURN RECEIPT
REQUESTED

RETURN RECEIPT
REQUESTED

PLACE STICKER AT TOP OF ENVELOPE TO THE RIGHT
OF THE RETURN ADDRESS. FOLD AT DOTTED LINE